

COMPT	DOORS	OPENING DIMENSIONS	INSIDE DIMENSIONS	VOLUME
L1	ROLL-UP	23.25'W x 49.50'H	29.75'W x 59.00'H x 17.75'D	18.07 CU. FT.
L2	ROLL-UP	53.25'W x 19.50'H	60.00'W x 26.25'H x 17.75'D	17.41 CU. FT.
L3	ROLL-UP	15.25'W x 49.50'H	24.75'W x 59.00'H x 17.75'D	14.99 CU. FT.
L4	ROLL-UP	43.25'W x 49.50'H	47.25'W x 59.00'H x 17.75'D	29.63 CU. FT.
A1	ROLL-UP	44.50'W x 20.50'H	53.00'W x 29.75'H x 47.75'D	43.87 CU. FT.

COMPT	DOORS	OPENING DIMENSIONS	INSIDE DIMENSIONS	VOLUME
R1	ROLL-UP	23.25'W x 35.00'H	29.75'W x 45.00'H x 22.75'D	17.62 CU. FT.
R2	HINGED	50.00'W x 9.25'H	60.00'W x 14.00'H x 22.75'D	11.95 CU. FT.
R3	ROLL-UP	18.75'W x 35.00'H	22.75'W x 45.00'H x 22.75'D	13.47 CU. FT.
R4	ROLL-UP	43.25'W x 35.00'H	47.25'W x 45.00'H x 22.75'D	27.99 CU. FT.
TOTAL VOLUME				192.75 CU. FT.

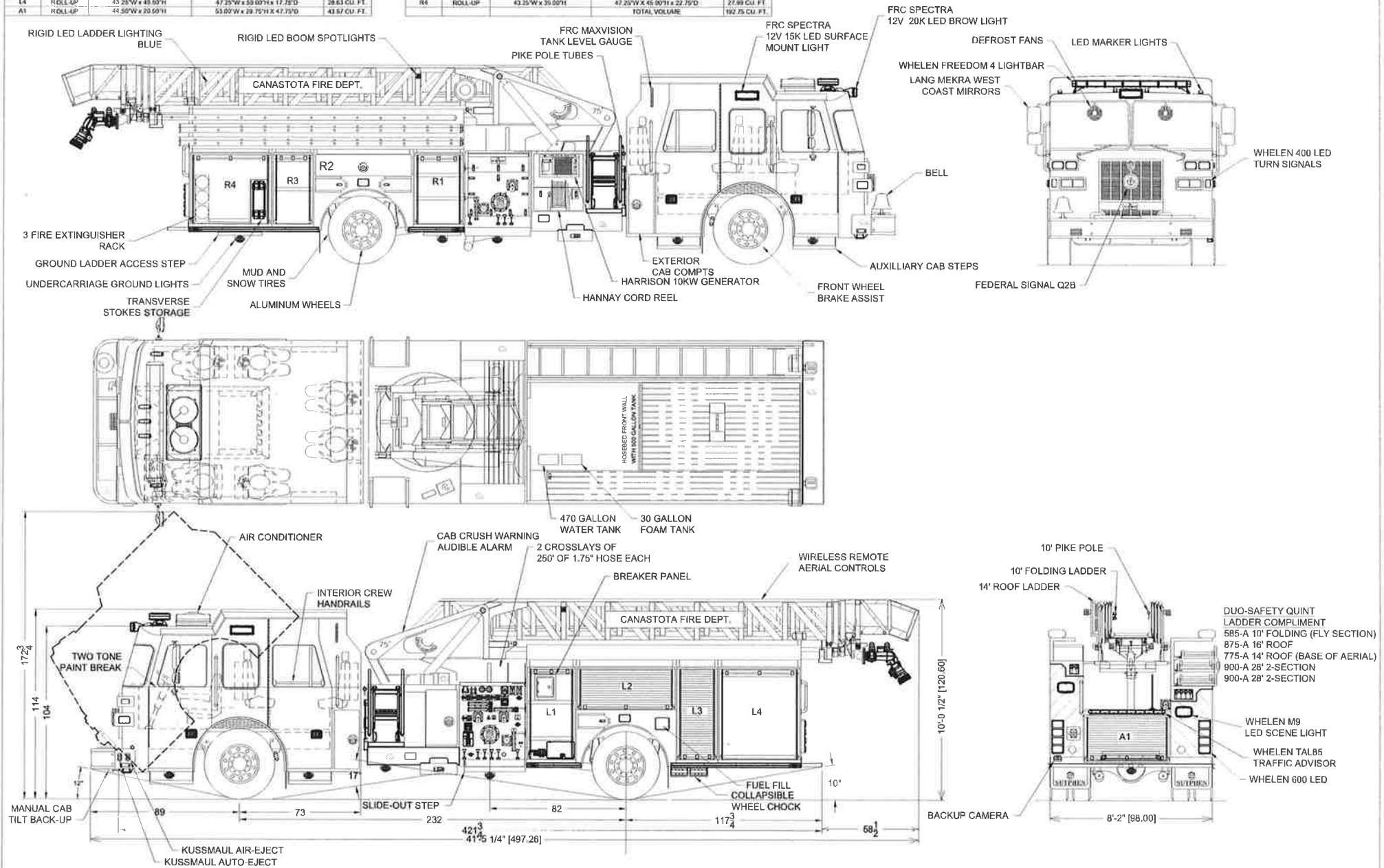

DIMENSIONS SHOWN ON THIS DRAWING ARE APPROXIMATE AND ARE SUBJECT TO MINOR DEVIATIONS DURING CONSTRUCTION

CUSTOMER APPROVAL

NAME:

TITLE:

DATE:

REV.

DESCRIPTION

BY

DATE

DRAWN BY:

APF

DATE:

11/29/16

MFG FACILITY

HELAND



CANASTOTA FIRE DEPT
CANASTOTA, NY

SL75
HS-5085

IN THE EVENT OF A DISCREPANCY BETWEEN THE SUTPHEN SPECIFICATIONS AND DRAWING, THE SUTPHEN SPECIFICATIONS SHALL PREVAIL.

DRAWING IS FOR REFERENCE ONLY. SOME ITEMS PROPOSED MAY NOT BE SHOWN OR NOTED.

THIS PRINT IS PROVIDED ON A RESTRICTED BASIS AND IS NOT TO BE USED IN ANY WAY DETRIMENTAL TO THE INTEREST OF SUTPHEN CORPORATION.